



TD-SILENT

5211360400 - TD-350/125 SILENT (230-240V 50/60) RE - IN LINE DUCT FANS



Low profile "Mixed-flow" fans with sound-absorbent insulation. Extremely quiet Certified of Approval Noise Abatement Society. Manufactured in plastic material, with a specifically designed internal skin to direct the sound waves at the right angle for them to be captured by the sound-absorbent material. Fitted with rubber gaskets on the inlet and outlet to absorb vibrations, a body that can be dismantled. Connection box can be rotated 360°, to facilitate easy connection of the power cable.

Motors

Speed controlable 230V-50Hz motor, of two speed motors. IP44. Motors are class B, with ball bearings and safety thermal overload protection.

Additional information

The models offer solutions to ventilation problems, especially in places where people work and low sound level is required.

Brand S&P model TD-350/125 SILENT (230-240V 50/60) RE for an airflow 330 m³/h and static pressure 0,999 Pa.

Theoretical Working Point

Airflow	330 m³/h
Static Pressure	1,00 Pa
Temperature	20 °C
Altitude	0 m
Density	1,2 kg/m³
Frequency	50 Hz
Voltage	1-230V-50Hz

Working Point

Airflow	330 m³/h
Static Pressure	0,999 Pa
Dynamic pressure	33,5 Pa
Total Pressure	34,5 Pa
Input power	0,027 kW
Outlet speed	7,5 m/s
Fan speed	2097 rpm
Specific Fan Power	0,30 W/l/s
Specific Fan Power reg	0,30 W/l/s

Construction

Discharge diameter	125 mm
Fan size	125
Weight	5,00 kg

Motor Characteristics

Number of poles	2
Voltage	1-230V-50Hz
Maximum absorbed current	0,1 A
IP Rating	IP44
Motor insulation class	B

Drawing

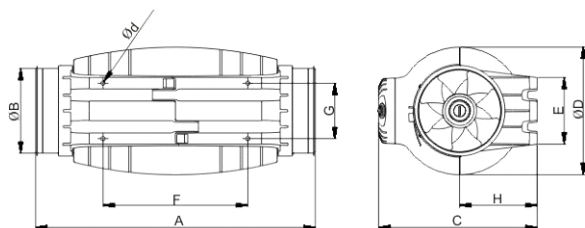

A	B	C	D	E	F	G	H
462	123	252	204	100	250	83	121

Performance Chart

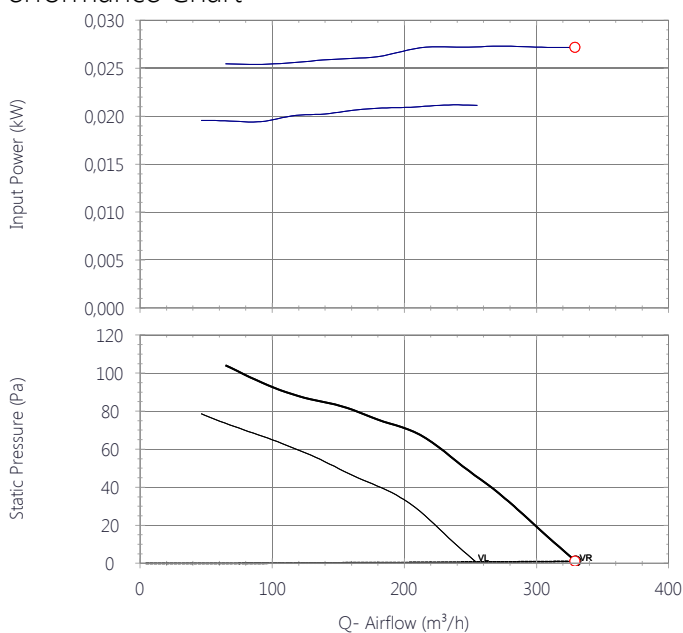

Sound Performance

	63	125	250	500	1k	2k	4k	8k	Overall
Inlet (LwA)	23	30	45	53	51	46	40	31	56
Inlet LpA @ 1m	12	19	34	42	40	35	29	20	45
Outlet (LwA)	23	31	44	51	49	43	38	31	54
Outlet LpA @ 1m	12	20	33	40	38	32	27	20	43
Breakout (LwA)	20	27	38	42	39	32	24	17	45
Breakout LpA @ 1m	9	16	27	31	28	21	13	6	34



Accessories

5401270300 - REB-1 N *230V 50*



Electronic speed controller

Dimensions

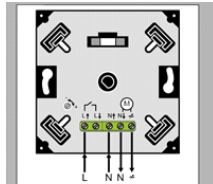

Modell	Zul. Gerätstrom [A]
REB-1 N	0,1 – 1,0
REB-2,5 N	0,25 – 2,5

A	B	C
80	22	46

5401271100 - REB-1 N E *230V 50*

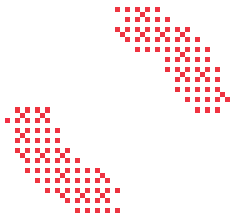

Electronic speed controller

5401620900 - CONTROL ECOWATT AC/4A (230Vac 50HZ)



Control element for demand controlled ventilation systems in public, commercial residential building it automatically modifies the fan speed to adapt it to the needs defined in the system, measured with sensors. It has three basic modes of operation: 1. Integral proportional control at constant pressure. 2. Proportional control with maximum demand criteria with multiple sensor input: temperature, CO2 and relative humidity. 3. Minimum-maximum control with three-sensor input: CO2, temperature, relative humidity or presence detectors (PIR). DC signal output of 1 to 10 V or signal output for AC voltage variation for single phase motors at 230 V. ECOWATT C CONTROL: for single phase ventilation units. ECOWATT C CONTROL: for DC ventilation units . Power supply:- AC model: 1~230 V. - DC model: 1~230 V or 24 VDC..

Dimensions

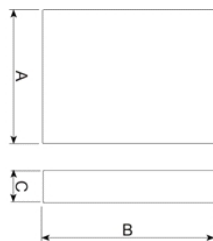

B	H	T
165	220	110



TD-SILENT

5211360400 - TD-350/125 SILENT (230-240V 50/60) RE - IN LINE DUCT FANS

5401259600 - COM-2

Two speed switch



Dimensions

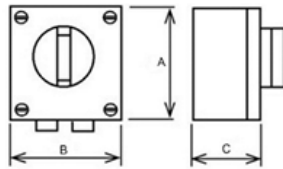

B	H	T
82	82	37

5416730700 - CPFL-E

Presence detector for ceiling mount, sensitive to infrared radiation emitted by bodies in movement, with a 360° detecting angle. Power supply: 1-230 V. CPFL-E: Flush mount model.



Dimensions

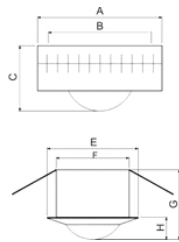

A	B	C	E	F	G	H
105	87	55	90	72	69	22

5416730600 - CPFL-S

Presence detector for ceiling mount, sensitive to infrared radiation emitted by bodies in movement, with a 360° detecting angle. Power supply: 1-230 V. CPFL-S: Surface model.



Dimensions

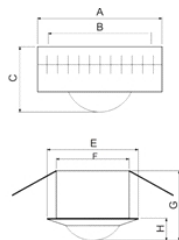

A	B	C	E	F	G	H
105	87	55	90	72	69	22



TD-SILENT

5211360400 - TD-350/125 SILENT (230-240V 50/60) RE - IN LINE DUCT FANS

5418061300 - MAR-250-350 S

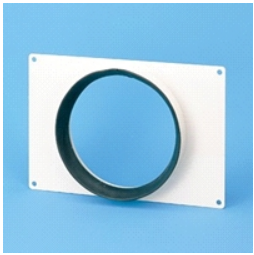

RECTANGULAR DUCT ADAPTERS - TD MIXVENT SERIES

Dimensions

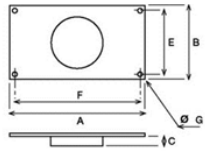

A	B	C	E	F	G
264	180	33.3	160	244	9

5211801500 - MBE-125/12B



Electric Heater Battery

Dimensions

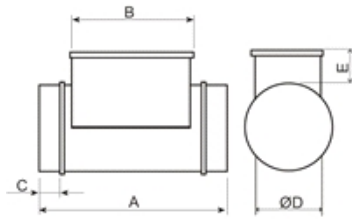

A	B	C	D	E
400	285	50	125	105

5418062700 - MBR-250-350 S

CIRCULAR CONNECTION FLANGE

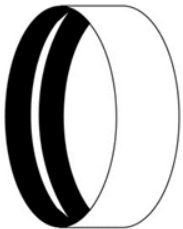

Dimensions



D
125



TD-SILENT

5211360400 - TD-350/125 SILENT (230-240V 50/60) RE - IN LINE DUCT FANS

5418062200 - MCA-350 S



Circular back draft shutter

Dimensions

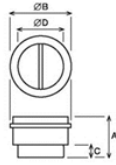

A	B	C	D
107	136	31.5	119.5

5416591500 - MFL-125 G4



MFL filtration boxes are of G4 grade filtration and are designed for direct connection with standard circular ducting. The MFL-G4 filtration boxes are supplied with a cover easily removable to replace the filter.

Dimensions

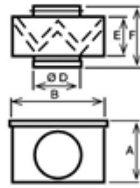

A	B	D	E	d
206	229	125	154	218

5418061700 - MPC-350 S



Flow detectors designed to correctly measure pressures at the inlet of series TD devices with airflow straightener.

Dimensions

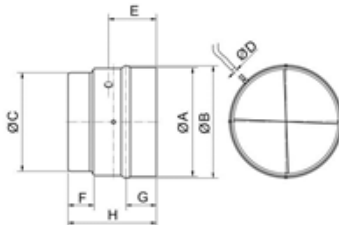

A	B	C	D	E	F	G	H
136	132	120	6	58	32	37	107

5418061100 - MRJ-250-350 S



Circular wire guard

Dimensions

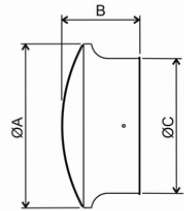

B	DI	NW	L
146	123	125	80

5407004100 - PRESOSTATO DPS 2-30

Differential pressure switch to control the fan running and the filter clogging up. Protection class: IP54. Can be used outside. From 20 to 300 Pa.



Dimensions

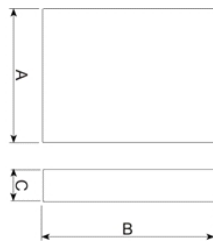

A	B	C
80	110	57

5401260400 - REGUL-2

Two speed switch



Dimensions

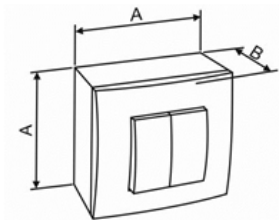

B	H	T
82	82	45



TD-SILENT

5211360400 - TD-350/125 SILENT (230-240V 50/60) RE - IN LINE DUCT FANS

5416739900 - RMVT-125 90/150



Motorised dampers for the twin-flow system. Minimum / maximum opening. Controlled by a presence detector acting on the motor of the damper. Power supply: 1-230 V.

Dimensions



D

125

5416731100 - SCHAT-AD



SCHAT-AD: Ambient CO2 sensor, temperature and relative humidity with display.

Dimensions

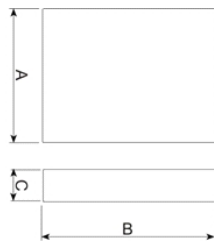

A	B	C
85	26	100

5416730800 - SCO2-A



SCO2-A: Ambient CO2 and temperature sensor.

Dimensions

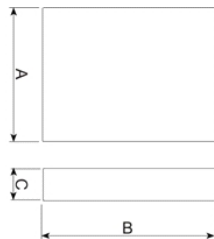

A	B	C
85	26	100



TD-SILENT

5211360400 - TD-350/125 SILENT (230-240V 50/60) RE - IN LINE DUCT FANS

5416730900 - SCO2-AD

SCO2-AD: Ambient CO2 and temperature sensor with display.



Dimensions

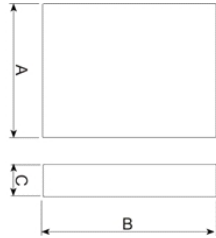

B	H	T
11	130	65

5211809800 - SIL-125

Silencer to be installed either at the inlet or outlet of the fan.



Corrections

63	125	250	500	1k	2k	4k	8k
-1	-3	-9	-20	-28	-35	-28	-13

5416731400 - TDP-D

TDP-D: Pressure sensor, with display. Enables you to control the pressure in the fan inlet.



Dimensions

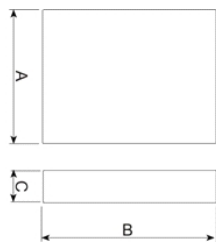

B	H	T
11	130	65



TD-SILENT

5211360400 - TD-350/125 SILENT (230-240V 50/60) RE - IN LINE DUCT FANS

5416731300 - TDP-S



TDP-S: Pressure sensor. Enables you to control the pressure in the fan inlet.

Dimensions

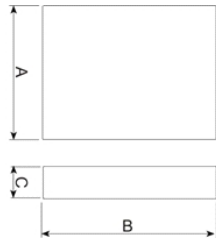

A	B	C
75	80	36

5401620500 - VAPZ-3



Electronic voltage regulator

Dimensions

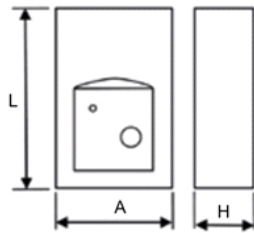

L	A	H
205	115	92